



Prime location !

Sold \$540,000

This beautiful brand new home ready to move in, perfect for first home buyer or investor, located in the heart of Harpley estate close to Wyndham Vale Primary school, Bus stop just steps away.

Close to Wyndham Vale station, This is a stunning opportunity for first home buyers or those looking to invest.

This beautiful home Comprising of four generous sized bedrooms with en-suite and walk in robe, all bedrooms have built in robe's, with two spacious living rooms,

An open plan kitchen with 20mm stone bench, 900mm stainless steel appliances and dishwasher, with ducted cooling and heating
Stepping outside there is alfresco family entertainment and a low maintenance backyard .

double automatic garage allows you to park 2 cars.

With so much more on offer.

- Good sized Master bedroom with an en suite and walk in robe.
- Remaining 3 bedrooms contain built in robes
- Formal lounge room.
- Open plan kitchen meals with an adjoining family room.
- Good size entertainment Alfresco area.
- Double automatic garage with rear access.
- Ducted heating and ducted cooling .
- Alarm security system
- Stainless steel appliances 900 mm./Dishwasher

Contact us to make an appointment because this one won't last long

For further inquiry please Call:
Glenda Del Pilar 0412 220 562

Please see the below link for an up-to-date copy of the Due Diligence Check List:

<https://www.consumer.vic.gov.au/duediligencechecklist>

DISCLAIMER: All stated dimensions are approximate only. Particulars given are for general information only and do not constitute any representation on the part of the vendor or agent.

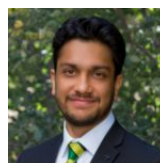

Taney Jain
0433 465 431
taney@reliancere.com.au



Glenda Del Pilar
0412 220 562
glenda@reliancere.com.au

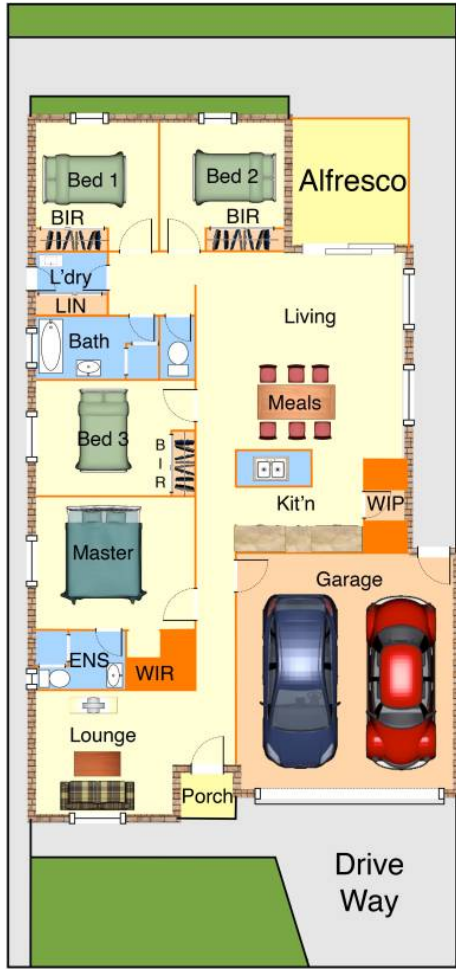

243 Black Forest Road Werribee

Floor Plan

